

Coffee oils & grinds accumulate in the outlet components of all coffee machines. This oil build up makes your coffee taste unpleasant and causes the shower screen and shower disc assembly to become blocked. This will result in little or no water flow through the brew head. The shower screen and shower disc should be cleaned approximately every 60-80 cups. This is not a manufacture fault and therefore is not covered under warranty Regular use of the Clean Machine Espresso Powder will safely & effectively remove coffee oil residue from your machine parts and ensure optimal machine performance. This cleaning process takes 5 minutes.



STEP 1. Turn machine off & allow to cool (15 to 20 minutes) and remove the power cord, cup rail, filter holder, water tank and the s/s grate and drip tray.



STEP 2. Place towel on a bench & gently lay the machine back.

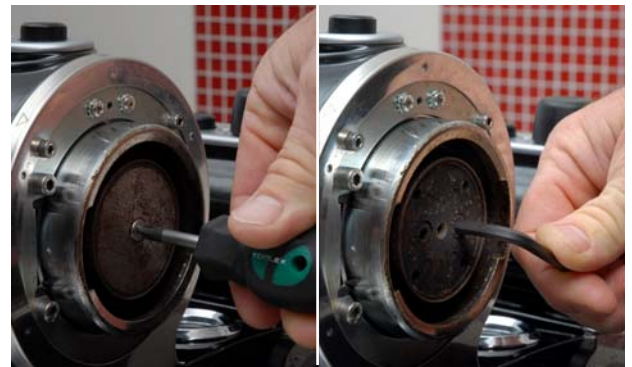

STEP 3. Using the Phillips Head screw driver, remove the screw in the centre of the shower screen & remove the shower screen, then using the 5MM Allen key, remove the 2 Allen screws in the shower disc assembly and remove (may require gently prying). Clean both sides to clear oils and grinds.



STEP 4. Place the shower disk assembly, screen, screws, filter holder & baskets into a small saucepan & add 1 heaped teaspoon of the cleaning powder and cover with boiled water and allow to stand for 10 minutes in a safe place.



STEP 5. After soaking flood with cool water in the sink to remove heat and then scrub with a nylon brush under running water until clean. **Please note:** Inspect the shower screen under light to confirm all holes are clean & free. If your shower disk is worn out you can purchase a new one, please quote **part number: G4176457** replacement screws are also available.



STEP 6. Scrub the brew head with a nylon brush and wipe clean with a damp cloth. **Please note:** If the black rubber gasket in the brew head has become hard to the touch or has been previously leaking, it may need replacing. The gasket may be gently pried out using a small flat bladed screw driver being careful not to scratch or dent the chrome finish. *For the replacement group part please quote part number: G4176454.*

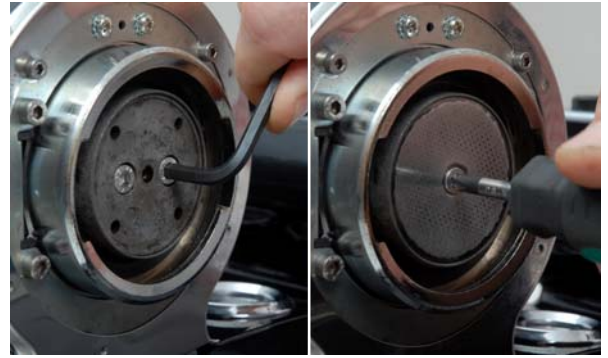

STEP 7. Reassemble the shower disc assembly and shower disc being careful not to over tighten screws as this cleaning process is required after approximately every 120 coffees.



STEP 8. Reassemble the drip tray, grate, cup rail & fill the water tank with fresh clean water & refit the filter holder. **Please note:** Flush through one cup of water and then re-season the machine by making an espresso and discarding. Your machine is now ready to use.

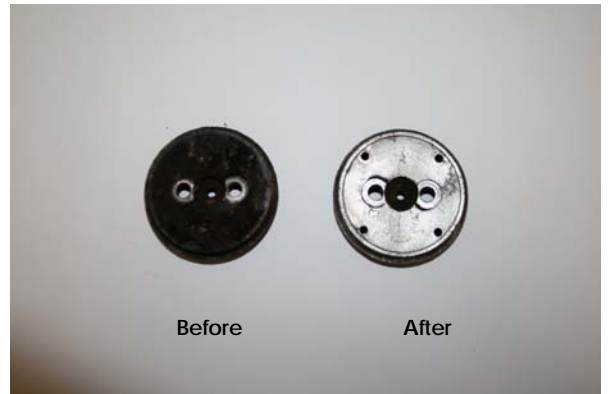

Shower disc before and after cleaning.
Note 4 holes completely blocked before cleaning

**FOR MORE INFORMATION
CONTACT:**

1800 990 990 within Australia
0800 881 200 from New Zealand
www.petermcinnes.com.au

**ESPRESSO BREW HEAD
CLEANING KIT**

To suit KitchenAid KPES 100 Espresso machine

Reorder Part Number 98022